



EASTRIDGE PARK

*Cottages at Eastridge Park
Available Lots - Phase 1D-F*

HAWKINS
HOMES AND COMMUNITIES

See Page 2 for the
Overlook at Eastridge
building lots

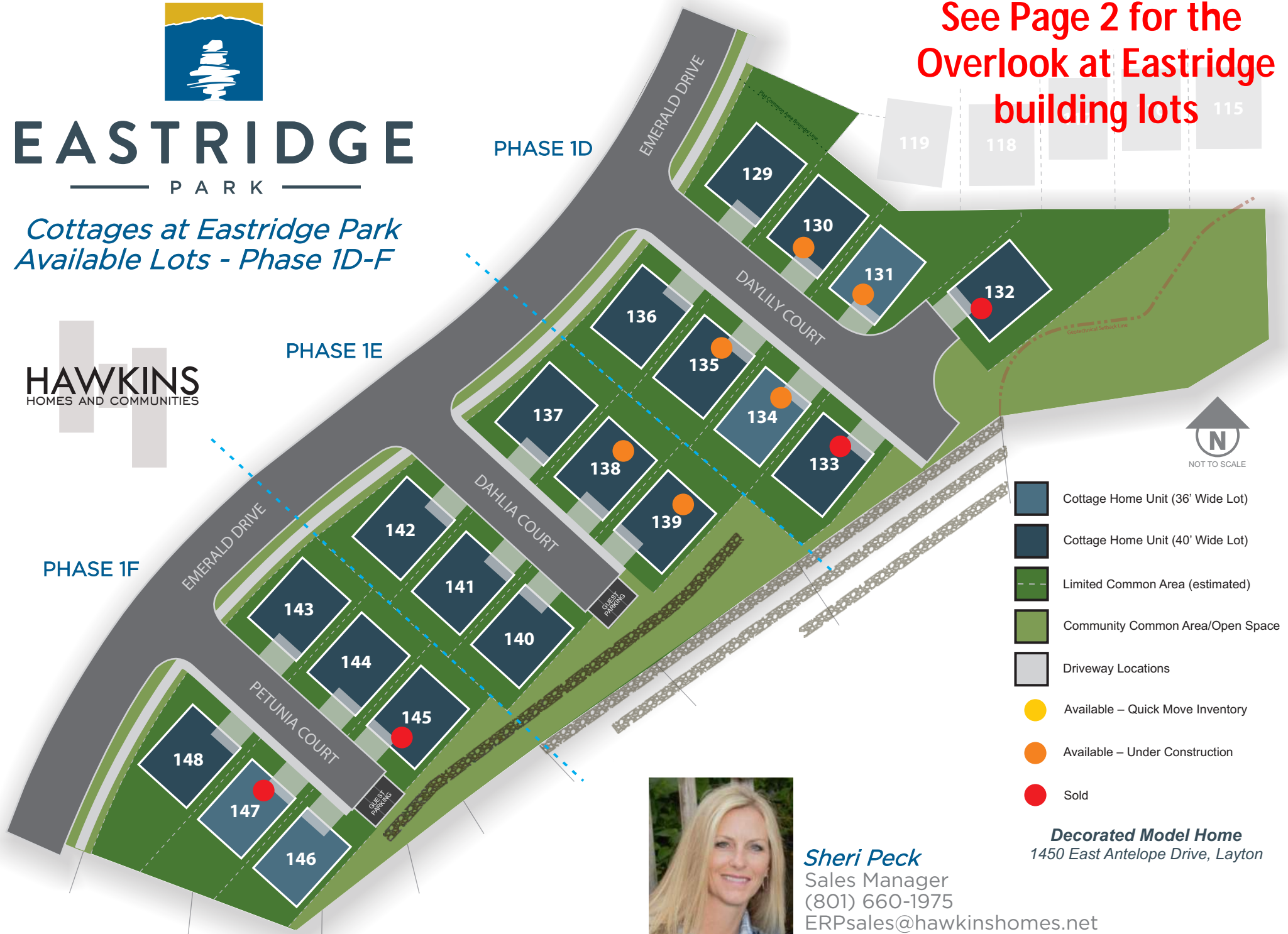

- Cottage Home Unit (36' Wide Lot)
- Cottage Home Unit (40' Wide Lot)
- Limited Common Area (estimated)
- Community Common Area/Open Space
- Driveway Locations
- Available – Quick Move Inventory
- Available – Under Construction
- Sold



Sheri Peck
Sales Manager
(801) 660-1975
ERPsales@hawkinshomes.net



Decorated Model Home
1450 East Antelope Drive, Layton

Please note: This plan is for general identification and location only. Plan is not to scale or proportionately reliable. Please refer to the recorded plats for specific lot information. See a Hawkins sales representative for specific details. ©2018 Hawkins Homes & Communities LLC (3/1/2018)



EASTRIDGE

PARK

*The Overlook at Eastridge Park
Available Lots - Phase 3B*



- Building Lot
- Available – Quick Move Inventory
- Available – Under Construction
- Sold

HAWKINS
HOMES AND COMMUNITIES

*Decorated Model Home
1450 East Antelope Drive, Layton*



Sheri Peck
Sales Manager
(801) 660-1975
ERPsales@hawkinshomes.net





EASTRIDGE

PARK

Community Map

This plan depicts the overall site layout and general improvement plan of the developer. This is an artists rendition and is for illustrative purposes only. They may not reflect the actual final building lots, plans, products, improvements, and/or specifications.

The locations of the Townhome and Cottage Home units are accurate. Lot lines between future Overlook Home lots may change as phasing is presented to the City for Final Plat approval.



Sheri Peck

Sales Manager

(801) 660-1975

ERPsales@hawkinshomes.net

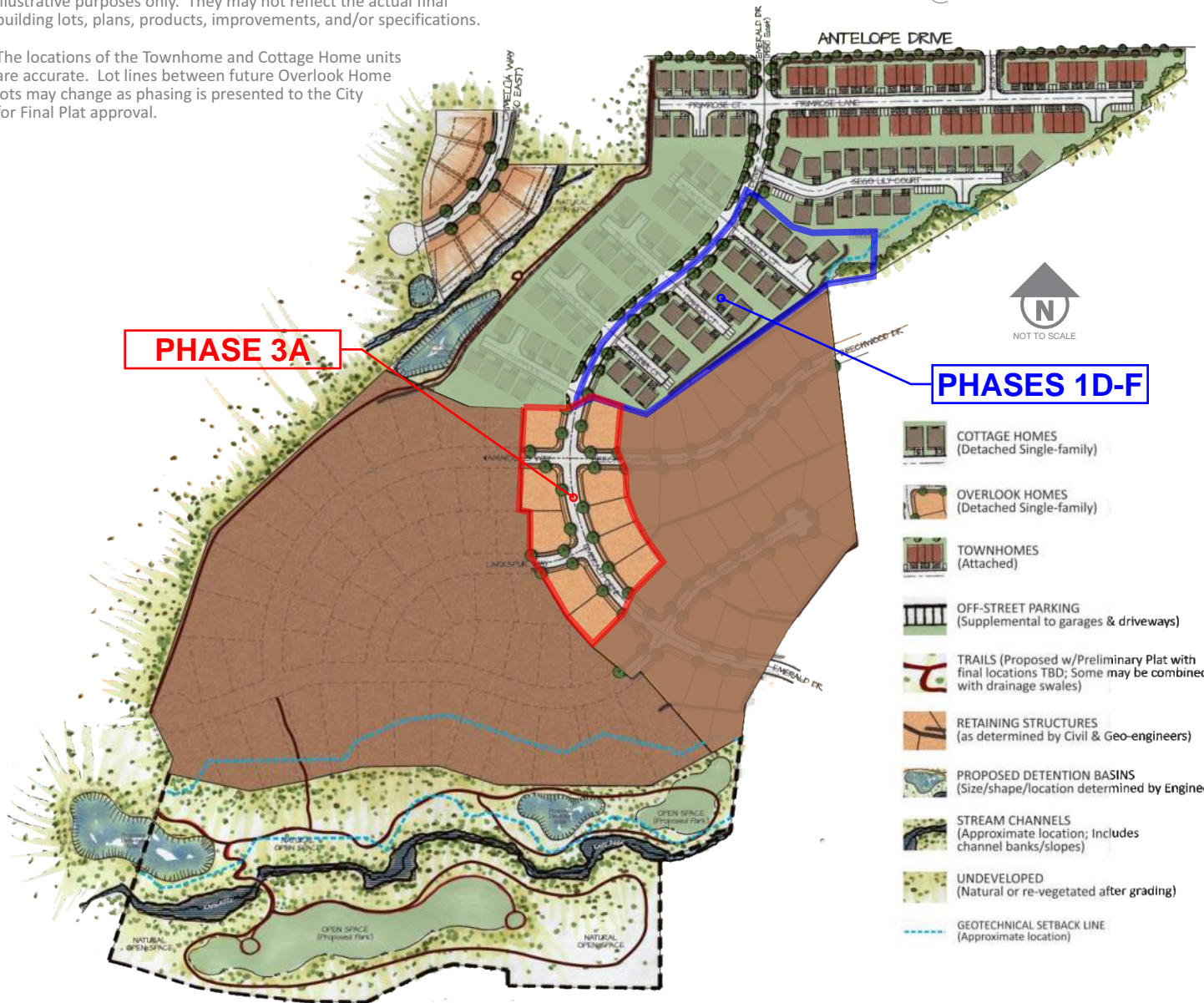

Please note: This plan is for general identification and location only. Plan is not to scale or proportionately reliable. Please refer to the recorded plats for specific lot information. See a Hawkins sales representative for specific details. © Hawkins Homes & Communities LLC 2018 – Reproduction or use of these drawings, in whole or in part, in any form and/or for any purpose, is prohibited without the express written permission of Adams Property LLC and/or Hawkins Homes & Communities LLC.